

DEVELOPMENT LAND EAST END

East End, East End & Colliers, Cayman Islands

MLS#: 417049

CI\$320,000

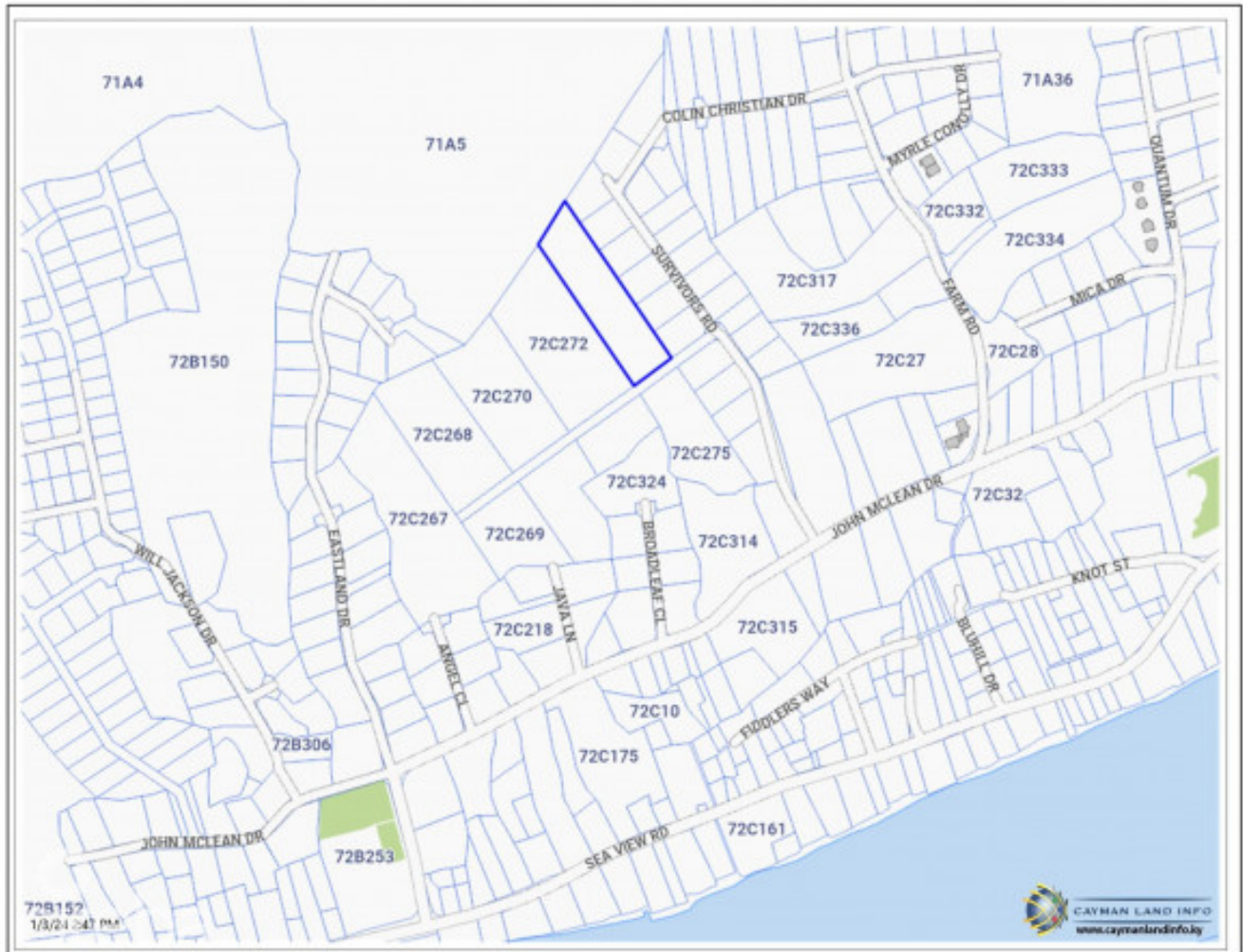

Residential developable land north of John McLean Drive generally 5ft above sea level. Suitable for subdivision into seven house lots or 36 apartments

Essential Information

Type	Status	MLS	Listing Type
Land (For Sale)	Current	417049	Residential

Key Details

Width	Depth	Block & Parcel
140.00	540.00	72C,274
Acreage		
1.8100		

Additional Fields

Lot Size	Views	Zoning	Road Frontage
1.81	Garden View	Medium Density Residential	140
Soil			
Rock			