

(31 Acres) 56 Bluff Edge Development Parcels At 150ft. The Highest Point In The Cayman Islands.

Cayman Brac East, Cayman Brac, Cayman Islands

MLS#: 418205

CI\$1,995,000

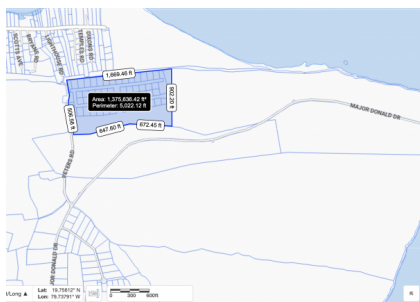

Andrew Gilbert MRICS
andrew@irg.ky

A fantastic one-of-a-kind opportunity to acquire a 31 acre parcel right on the Bluff Edge, already split into 56 subdivided house plots ranging from 0.23-0.43 acres in size and with direct access off Peters Road. There is nothing else like this on the Bluff Edge which allows someone to come in and develop with the most elevated views in the Cayman Islands at 150ft. This is the single highest point in all of the Cayman Islands. This land also attaches to the famous Nature Lighthouse trail allowing future home owners access on their doorstep to the beautiful surrounding area. This opportunity is subject to a future subdivision required from Parcel 111A73 which the Vendor's will undertake once an offer is accepted. Images provided by Lands & Survey

Essential Information

Type
Land (For Sale)

Status
Withdrawn

MLS
418205

Listing Type
Residential

Key Details

Width
1669.00

Depth
902.00

Block & Parcel
**111A,(PART)73&13-6
8**

Acreage
31.0000

Additional Fields

Lot Size
31

Views
Water View

Land Certificate
Not Issued