

## DEVELOPMENT LAND EAST END

## East End, East End & Colliers, Cayman Islands

MLS#: 417049

**CI\$400,000**

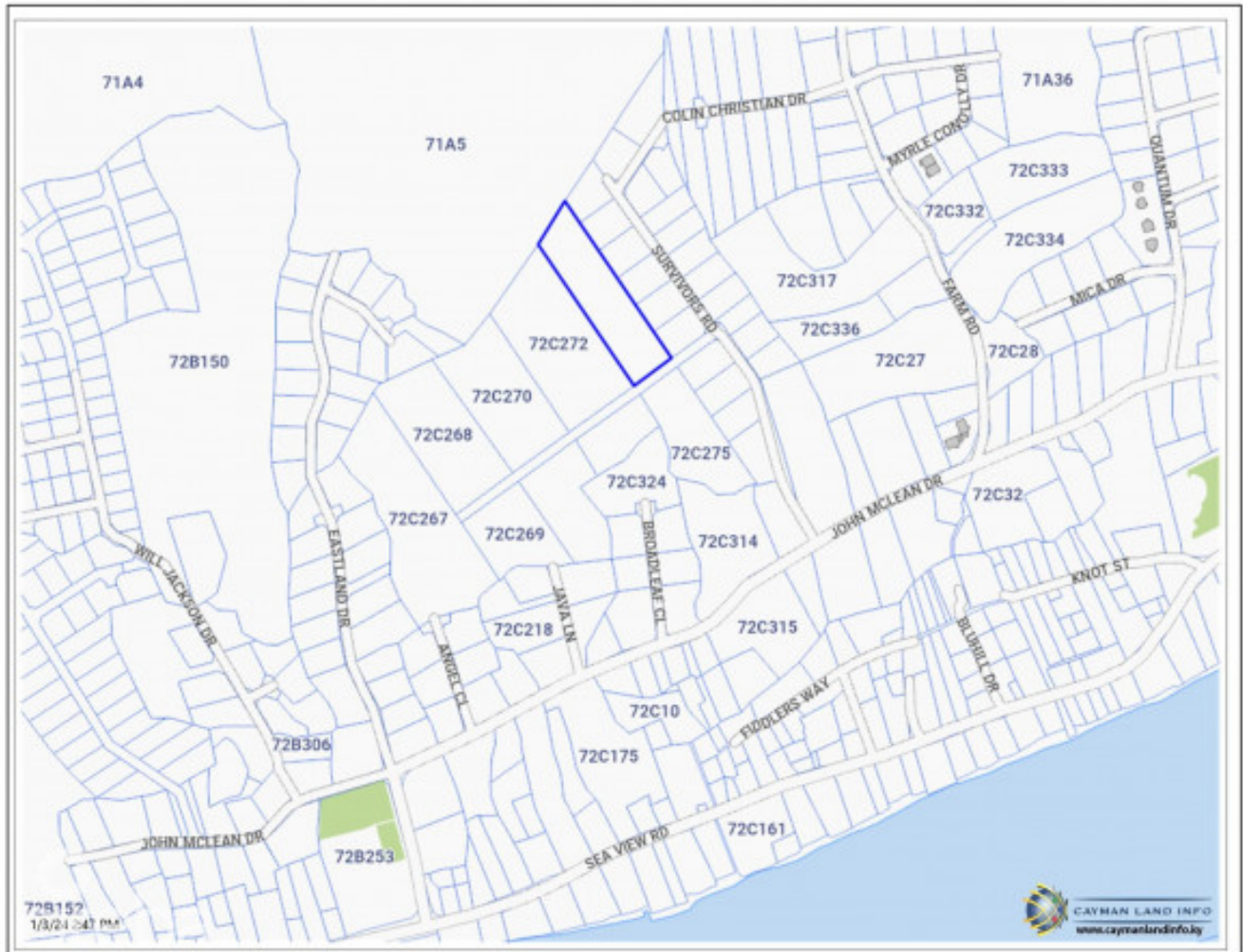

Residential developable land north of John McLean Drive generally 5ft above sea level. Suitable for subdivision into seven house lots or 36 apartments

## Essential Information

Type	Status	MLS	Listing Type
<b>Land (For Sale)</b>	<b>Current</b>	<b>417049</b>	<b>Residential</b>

Key Details

Width	Depth	Block & Parcel
140.00	540.00	72C,274
Acreage		
1.8100		

Additional Fields

Lot Size	Views	Zoning	Road Frontage
1.81	Garden View	Medium Density Residential	140
Soil			
Rock			