

0.34 BEACH BAY LAND WITH DUPLEX PLANS

Savannah / Lower Valley, Grand Cayman, Cayman Islands



INTERNATIONAL REALTY GROUP LTD.



128
WIDTH



225
DEPTH

Property Description

Amazing opportunity to own 0.34 acre in a prime location with approx. 21ft - 26ft above sea level. This great investment or started home comes with duplex plans that can be modified. Close to many amenities such as Country side shopping village, Country Corner, Gas stations, many restaurant's, schools and so much more.. We can't forget the amazing beach right down the road (5-10mins walking distance). Beach Bay is a growing community, there is no doubt that this area value will continue growing. With the potential hotel development, this will bring opportunity for easy rentals such as Airbnb. On this property you can find papaya tree, neem tree and cerasee tree. Contact me today for more information! P.S. Motivated Seller

CI\$195,000

MLS#: 413395

TYPE: Residential (Land)

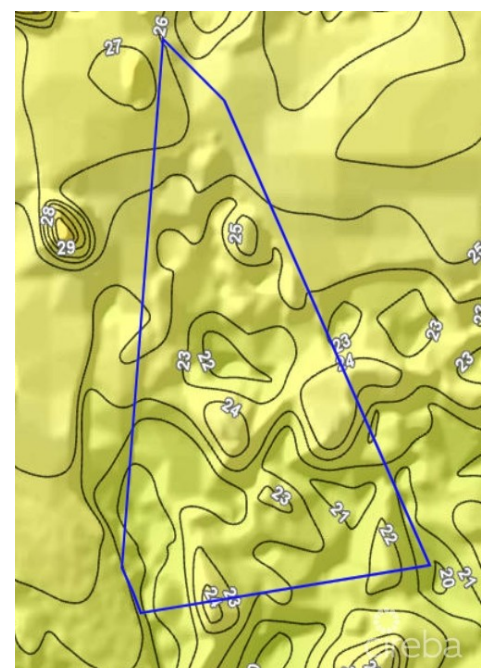

0.34 BEACH BAY LAND WITH DUPLEX PLANS

Savannah / Lower Valley, Grand Cayman, Cayman Islands



INTERNATIONAL REALTY GROUP LTD.



CIREBA MLS LDX feed courtesy of CENTURY 21 THOMPSON REALTY

*Disclaimer: The information contained herein has been furnished by the owner(s) and or their nominee and represented by them to be accurate. The listing company, agent and CIREBA MLS disclaims any liability or responsibility for any inaccuracies, errors or omissions in the represented information. The listing details herein are also courtesy of CIREBA (Cayman Islands Real Estate Brokers Association) MLS and/or via LDX (Listing Data Exchange) feed. All the information contained herein is subject to errors, omissions, price changes, prior sale or withdrawal, without notice and is at all times subject to verification by the purchaser(s).